

**PERMIT NOTE**

1. ALL PULLBOXES, CONDUITS, PANELS AND LIGHTING CONTROLS ARE EXISTING TO REMAIN AND HAVE BEEN INSTALLED AS PER APPROVED PERMITS IN PHASE 1.

**PHASE 1 PERMITS:**

- CITY #17-1G7161
- FDOT #2016-C-496-0020-93060
- DEP #PB-1209

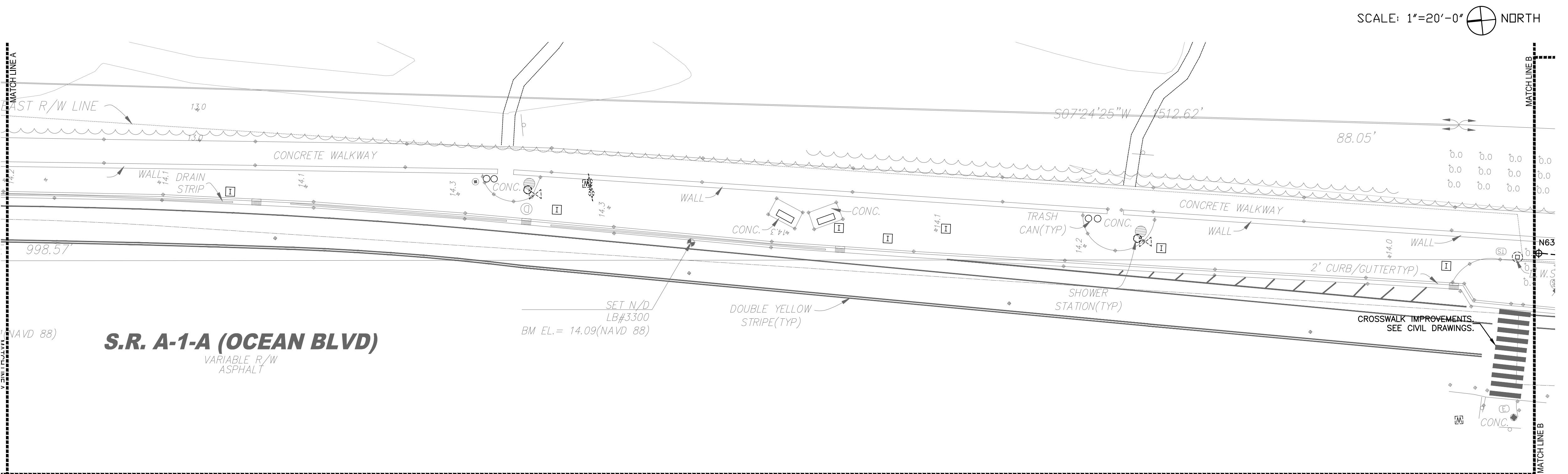

**1 PARTIAL ELECTRICAL PLAN**  
SCALE: 1"=20'-0" NORTH

ELECTRICAL WORK STARTS ON SHEET E-102

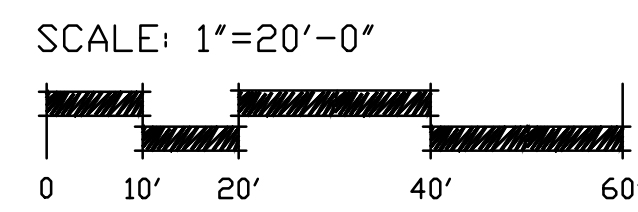

**CITY of DELRAY BEACH**  
ENVIRONMENTAL SERVICES DEPARTMENT  
434 SOUTH SWINTON AVENUE, DELRAY BEACH, FLORIDA 33444  
Phone: (561) 243-7322 Fax: (561) 243-7060 www.mydelraybeach.com

**LANDSCAPE ARCHITECT**  
EDSA, INC.  
1512 E. BROWARD BOULEVARD SUITE 110  
FORT LAUDERDALE, FLORIDA 33301

**MECHANICAL, ELECTRICAL, AND PLUMBING**  
CREDO CONSULTING ENGINEERS  
800 E. BROWARD BOULEVARD SUITE 601  
FORT LAUDERDALE, FLORIDA 33301

**DESIGNED BY** MG  
**DRAWN BY** NG,OL  
**CHECKED BY** MG  
**DATE** JANUARY 2019

**REVISIONS**

REV	DATE	DESCRIPTION	BY

**BEACH MASTER PLAN - PH 2**  
ISSUED FOR BID

**PHASE 2 - ISSUED FOR BID**  
ELECTRICAL PLANS (PARTIAL 1 OF 7)

**PROJECT NO.**  
15-008 (2)

**SHEET NO.**  
E-101

**FILE ID.**